

CERTIFICATE

CERTIFIED LAND CORNER

No. 78

2170222000

I, Gary L. Dechant, do hereby certify that on the 1st day of June 1992, I found (evidence) ~~(no evidence)~~ of the E/4 corner of Sec. 22, T 17 N, R 2 W Fourth Principal Meridian, and I re-established said corner according to the Wisconsin Statutes as shown and described hereon.

History of corner establishment since Original Government Survey

No known recorded history since the original government survey.

Description of corner evidence found:

Accepted fence corner as best available evidence, fits overall section datum very well.

Dated this 9th day of June 1992.

Gary L. Dechant

Reg. Land Surveyor, S-1744
Title

COUNTY SURVEYOR FORM NO. 1

Description of corner and witness monuments, references and accessories used to perpetuate the original or re-established location of this corner:

Witnesses to corner location:

David E. Madison

Gary L. Dechant

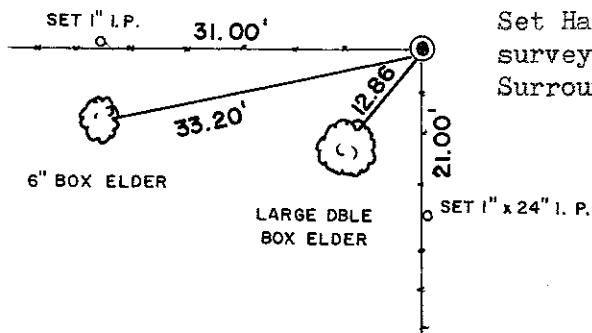
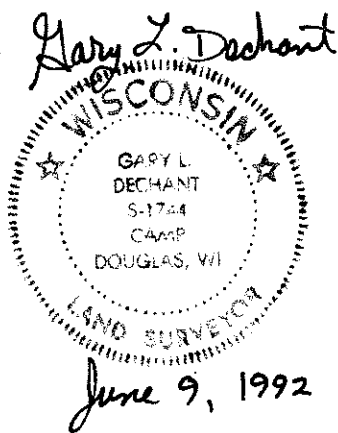

Set Harrison Monument, survey sign 1' south. Surrounded by open fields.

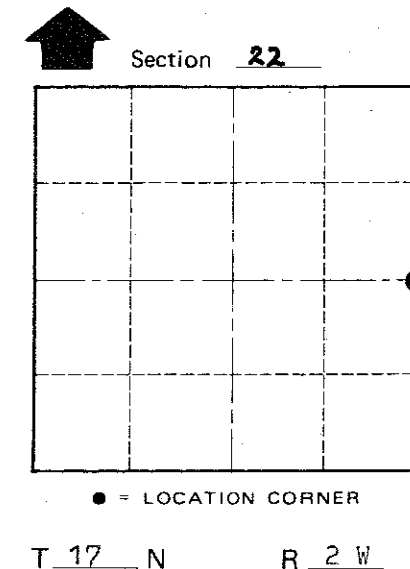

● = LOCATION CORNER

T 17 N R 2 W

WISCONSIN

(Trees double blazed with 20d nail set)

SURVEY CONTROL ORDER

Horizontal _____
Vertical _____

WISCONSIN COORDINATE SYSTEM

Corner	East (X)	North (Y)	Elevation (Z)	Zone
Control Sta. Name				

~~City, Village or~~ Town Adrian

County of Monroe