

CERTIFICATE

I, Bryan H. Meyer, do hereby certify that on the 13th day of February 19 92, I found (evidence) ~~no evidence~~ of the East 1/4 corner of Section 32, T 16 N, R 2 W Fourth Principal Meridian, and I re-established said corner according to the Wisconsin Statutes as shown and described hereon.

Dated this 31st day of Dec. 1992.

Bryan H. Meyer  
Deputy County Surveyor  
Title

CERTIFIED LAND CORNER

History of corner establishment since Original Government Survey

Kenyon or Neuman was here in April of 1883.

Description of corner evidence found:

I found what I believe to be the NW original bearing tree. I found a 24" White Oak with a definite scar on the SE side at the appropriate direction and distance from a four-way fence corner. I am surprised that the tree is only 24" in diameter (it was 6" as marked in 1847), however it stands on a steep hillside. This may account for it's small size.

Description of corner and witness monuments, references and accessories used to perpetuate the original or re-established location of this corner:

Crew: Meyer, Kenworthy  
Date: February 13, 1992  
Weather: Overcast, Misty, 30°±  
Witnesses to corner location:

Bryan H. Meyer  
John Kenworthy

ORIGINAL GOVERNMENT BEARING TREE: 24" White Oak

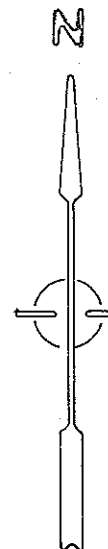
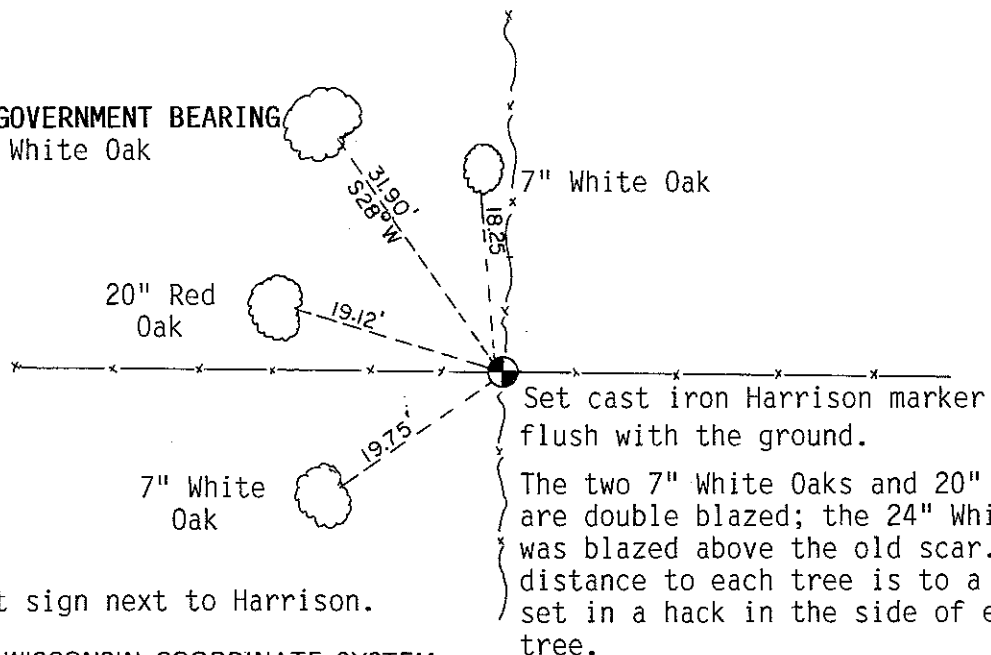

No. 116  
**2160232200**

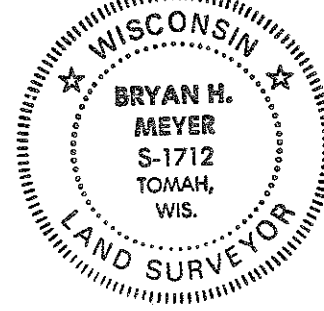

H. A. Sime and Associates  
P. O. Box 705  
Tomah, Wisconsin 54660  
Phone: (608)-372-5392

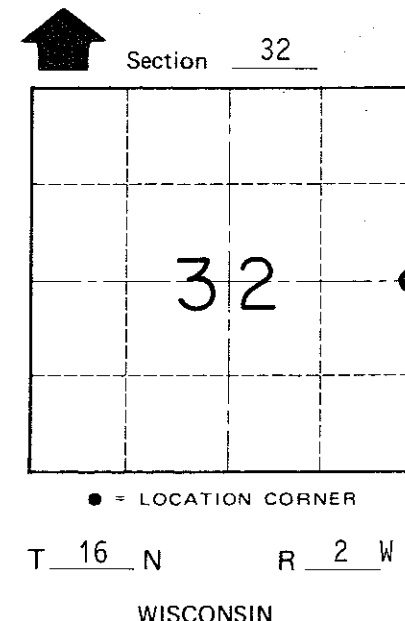

COUNTY SURVEYOR FORM NO. 1

SURVEY CONTROL ORDER

Horizontal	_____
Vertical	_____

WISCONSIN COORDINATE SYSTEM

Corner	East (X)	North (Y)	Elevation (Z)	Zone
Control Sta. Name				

~~City, Village or~~ Town of Ridgeville  
County of Monroe