

CERTIFICATE

CERTIFIED LAND CORNER

No. 65

21602150000

I, Harley A. Sime, do hereby certify that on the 11th day of Nov. 19 74, I found (evidence) (~~no evidence~~) of the SE corner of Section 15, T 16 N, R 2 W Fourth Principal Meridian, and I re-established said corner according to the Wisconsin Statutes as shown and described hereon.

History of original corner establishment:

A.S. Ingalls was at this corner in May of 1873.

Description of corner evidence found:

Reset an existing 3/4" iron bar with a Harrison Monument, down 2" below ground surface.

Dated this 7th day of Feb. 1978.

County Surveyor
Title

**Approved: HARLEY A. SIME
MONROE CO. SURVEYOR**

Description of corner and witness monuments, references and accessories used to perpetuate the original or re-established location of this corner:

Witnesses to corner location:

D. Marten

North

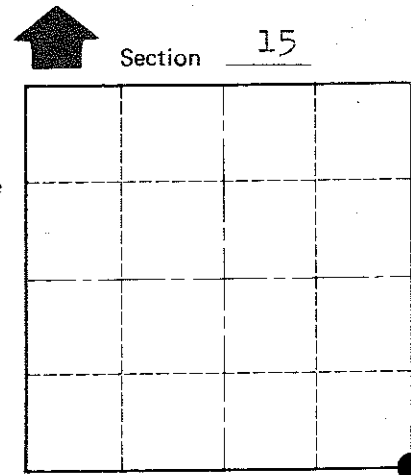
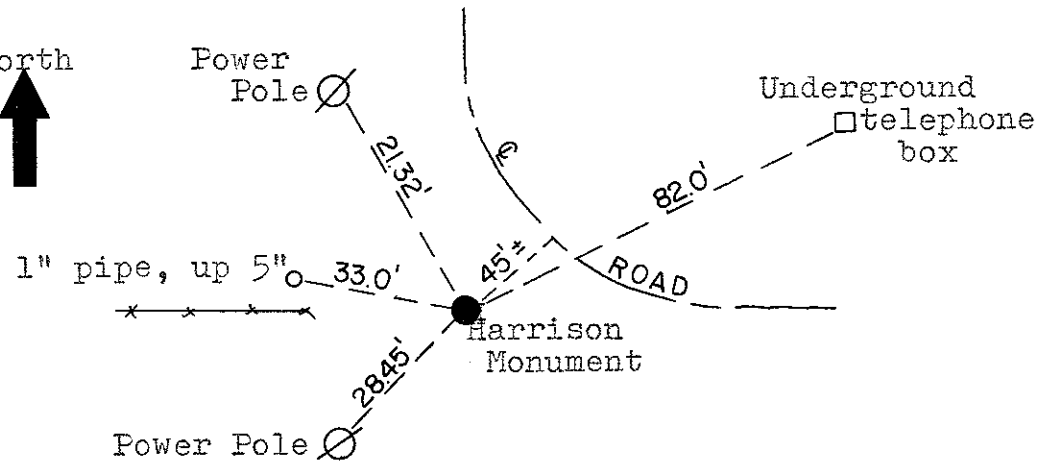

O = LOCATION CORNER

T 16 N R 2 W

WISCONSIN

COUNTY SURVEYOR FORM NO. 1

SURVEY CONTROL ORDER

Horizontal	_____
Vertical	_____

WISCONSIN COORDINATE SYSTEM

Corner	East (X)	North (Y)	Elevation (Z)	Zone
Control Sta. Name				

City, Village or Town Ridgeville

County of Monroe